

FABRICATED BASKET STRAINERS

BF FIRELINE SERIES

Design Features

- Standard sizes from 2" - 24". Larger sizes available upon request.
- Flanged to BS 10 TAB 'E' or Butt-weld end connections.
- Standard thru bolt cover design.
- 3mm Perforated screens are standard.
- May be installed in horizontal pipelines.
- Drain/ vent with plug is standard .

Dimensions

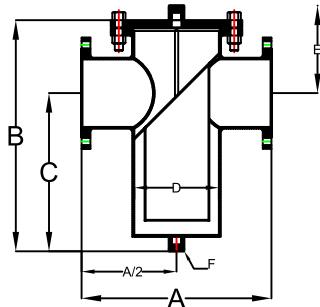

Size	A	B	C	D	E
25	175	277	177	33	227
40	218	325	213	48	275
50	264	361	232	60	320
65	267	439.5	302.5	76	395
80	315	510.5	348.5	89	463
100	349	611	418	114	575
150	406	982	797	165	872
200	536	1126	904	219	1036
250	609	1304	1044	273	1214
300	678	1503	1199	324	1403
350	760	1669	1337	356	1579
400	799	1996	1561	406	1831
500	908	2274	1818	508	2152
600	1000	2854.5	2354.5	600	2698
700	1100	3174	2574	700	3094
750	1100	3413	2763	750	3292
900	1575	4080	3242	900	3930
1000	1800	4401	3456	1000	4338
1100	1955	4836	3791	1100	4740

- Net free straining area minimum 4 times for standard screens
- Hydro tested to 12 bar
- Qualified welders as per ASME SEC VIII.DP on welds are standard.
- Covers are Flanged to BS 10 TAB "E" with Drain plug
- Differential pressure ports with plug is Standard
- Post Box red , high temperature resistant paint
- Heat resistant gaskets are standard
- Fasteners with spring washer is standard to provide for thermal expansion
- Class A ERW Pipe Body



Material Data

COMPONENT	MATERIAL
Body	CS TO IS1239,3589 Class A / CS TO IS 2062
Cover	CS TO IS 2062
Fastener	CS TO IS 1367 Gr 4.6 with spring washer
Gaskets	Heat Resistant Gaskets
Drain / Vent Plug	A105, CS TO IS 1875-II
Filter Element	SS 202

Standard Screens

SIZE RANGE	OPENING
2"-24"(50mm-200mm)	0.125" (3mm)