

FABRICATED FLANGED Y STRAINERS

YFS SERIES

Design Features

- Standard sizes from 2" - 24".
- Flanged to ANSI, DIN, IS, BS and Butt welded connections are available
- Rated to 150 lbs and 300lbs as standard. Higher ratings can be made on request.
- Bolted covers are standard
- May be installed in horizontal or vertical pipelines.
- Qualified welders as per ASME SEC VIII.DP of welds are standard
- Radiography of welds can be done on request
- Custom cover thickness and Dia to suit operating pressure.
- Drain/blow off connections are provided with plugs as standard
- Vents, differentials and special covers are optional.
- Medium pressure drop
- Net free straining area 4 times pipe c/s area for 3 mm hole dia/ least restrictive method for 40 mesh lined Strainers.



Material Data

COMPONENT	MATERIAL
Body	IS1239,3589 ASTM A106, SS304/316, DUPLEX STEEL
Cover	A105, SA 516 GR 70, CS TO IS 2062, SS316,304, DUPLEX STEEL
Fastener	CS TO IS 1367 with spring washer. SS 304/316
Gaskets	CAF, NACF, Neoprene, Nitrile, PTFE
Drain Plug	A105, CS TO IS 1875-II, Stainless Steel
Filter Element	SS 304,316, Duplex, Brass, Monel, Hastalloy C

Standard Screens

SIZE RANGE	OPENING
2"-8"(50mm-200mm)	3mm hole dia perforated sheet
14"-24"(350mm-600mm)	6mm hole dia perforated sheet lined with 40 mesh

Dimensions

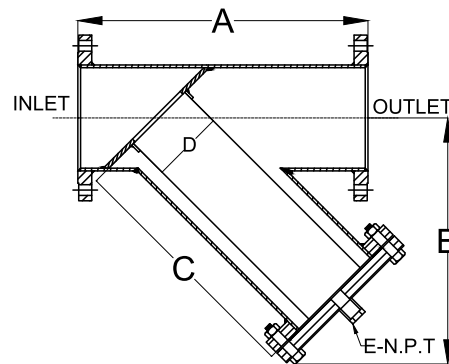

Size	A	B	C	D	E
40	245	140	122	30	1/2"
50	270	162	143	40	1/2"
65	290	190	176	55	3/4"
80	310	221	209	70	3/4"
100	380	288	286	80	3/4"
125	355	353	358	100	3/4"
150	470	402	412	125	3/4"
200	600	538	573	160	1"
250	750	642	682	210	1"
300	900	740	793	260	1"
350	1000	846	905	310	1"
400	1100	918	977	375	1-1/2"
450	1250	1041	1117	415	1-1/2"
500	1150	1128	1205	475	1-1/2"
600	1500	1415	1541	535	1-1/2"
700	1670	1770	2040	550	1-1/2"
800	1800	1959	2255	650	1-1/2"